

Ecology



New Bat Roost Building
Pendower is home to an amazing variety of Bats and it is very important to us to keep it that way. In collaboration with the bat specialist and ecologist, we have designed a new dedicated bat roost building which we are hoping will be an even better place for the bats to roost than the existing buildings.



Educational Information
We are looking forward to preparing and installing information boards to explain and educate about the special plants, animals and environment here at Pendower. The boards will also encourage people to look after the environment themselves, with ideas and suggestions of how to do that.

Site Map



Green Roofs
Green roofs provide space for plants & insects on and around the buildings.



Bird Boxes
These built-in features allow birds to nest within the walls of buildings.

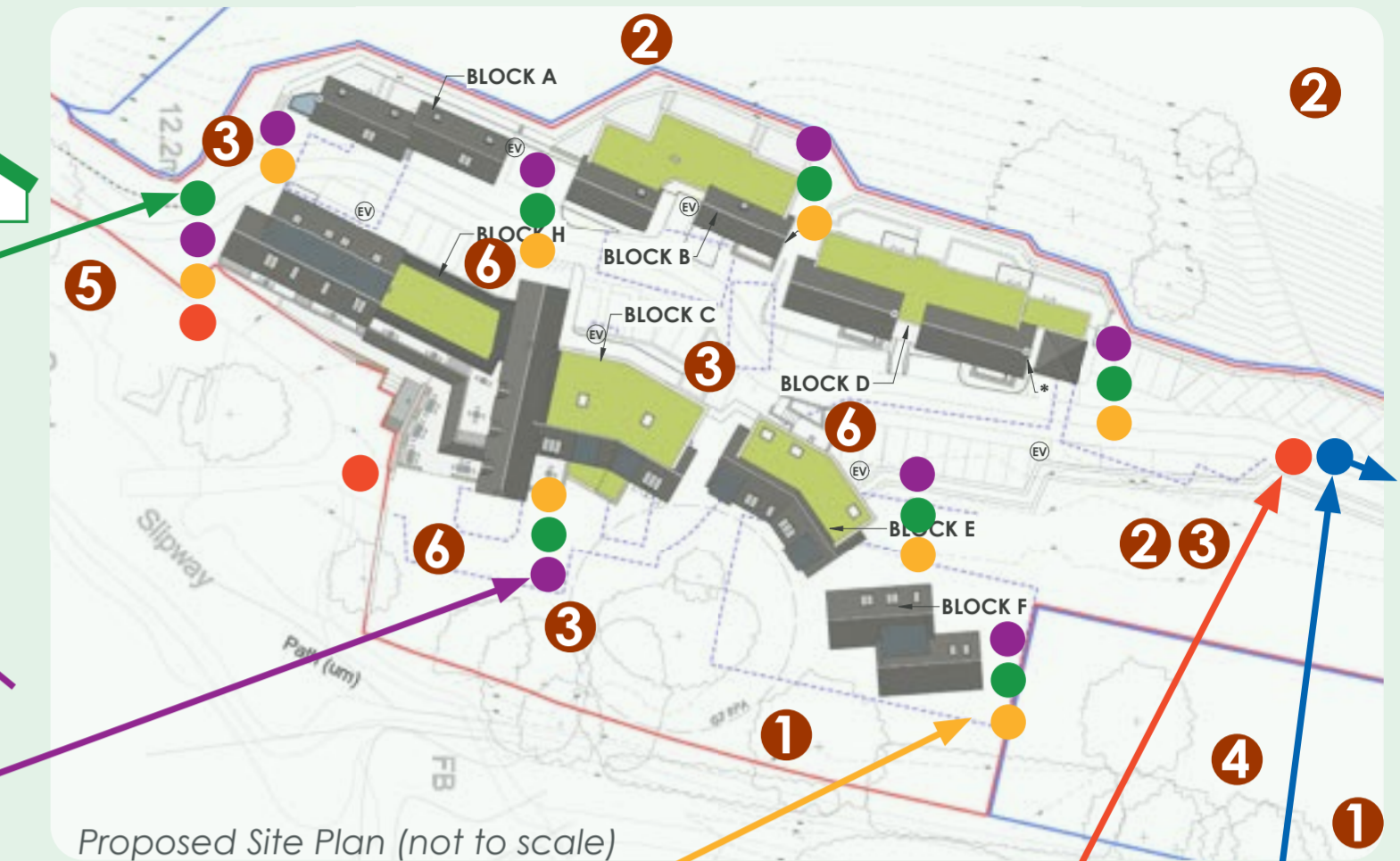

Bee Bricks
These specialist bricks are designed to provide habitats for solitary bees.



On site analysis and enhancements

We have been working with a team of Ecologists from **GE Consulting**, who are regularly checking the site and advising on the best solutions to protect and enhance the environment for local plants and animals.

Our aim is to increase bio-diversity on the site by removing historic rubbish and pollution, ornamental and invasive plants, replacing them with native species to provide improved areas for native insects and animals.

The buildings have been designed to limit light spill onto the stream area, an important navigation route for bats. Some walls have no windows at all!

Construction impacts

A Construction Environmental Management Plan (CEMP) is being produced by a team of Ecologists and Contractors to ensure the construction has as little impact on the local environment as possible. The CEMP will be thoroughly evaluated by Cornwall Council.

These proposals are subject to an Environmental Impact Assessment which is a process that protects sensitive sites through evaluating proposals in terms of impacts during construction and operation.

Landscape Design and Features

Retain and protect existing on-site willow scrub habitats (1), and scrub bank managed to provide a mosaic of habitats of benefit to reptiles and plants (2).



Design and planting for bio-diversity gain (3). Cornish hedgebanks of living, planted walls, coastal meadows, wet woodland ponds (4) and native planting.



Potential shore dock habitat (a protected coastal species(5)) on the cliffs and near the stream will be protected and impacts to overwintering birds in Gerrans Bay will be avoided.



Carefully designed lighting to allow nocturnal animals to display normal behaviour.

